

RESEARCH PROJECT STUDENT EXPO

Student Exhibitors

Booth	Research Project Title
4 & 5	<p>How can SHC holistically improve its connection with the Davenport community?</p> <p>How is the quality of life for a person with renal failure impacted by renal transplant and or dialysis?</p> <p>What are the differences in the challenges faced by Irish Migrants coming to Australia now, compared to 40 years ago?</p> <p>What is the most effective fitness programme for an adolescent footballer transforming into an elite AFL footballer?</p> <p>How do media stereotypes impact the lives of Muslim women in contemporary Western society?</p>
10	<p>Should protein bars be readily available at Total Image Dance Company?</p> <p>How effective can a dance piece be in sending a message to a 13/14 year old?</p> <p>Influence of emotional suppression on high school students</p> <p>Use of faecal micro biota transplants</p>
16 & 17	<p>What are the post-birth uses of the placenta?</p> <p>How does animal intelligence compare to human intelligence?</p> <p>Can I choreograph a hip hop routine for a novice dancer?</p> <p>Assistance for EALD students</p> <p>How can the skills, knowledge and abilities taught in STEM contribute to increased career opportunities?</p> <p>Endangered species in Borneo and Sumatra</p>
18 & 19	<p>How has the contemporary feminist movement impacted the characterisation of female heroines in western literature?</p> <p>Has climate change affected South Australia's climate over the past 10 years?</p> <p>How have female character stereotypes evolved in gaming over the last 15 years?</p> <p>To what extent are doctors prescribing medication and diagnosing patients based on an informed medical history?</p> <p>How do legal nausea drugs taken throughout pregnancy affect children's physical development</p>
20	Does Altitude Training have an impact on the performance of elite athletes at sea level
22	<p>Can I restore a Stihl Chainsaw on a budget?</p> <p>What preparation is required to perform in a Drag Show?</p> <p>Tattoos and me - my real life experience of getting a tattoo</p>

Program & map
Tuesday 8 August 2017

sace.sa.edu.au/expo2017

  [@saceboard](https://twitter.com/saceboard) [#RPstudentexpo](https://www.instagram.com/saceboard)

Booth	Research Project Title
23	<p>How does graded exercise therapy (GET) compare to cognitive behavioural therapy (CBT) in efficacy for treating symptoms associated with CFS/ME?</p> <p>How reliable are eyewitness testimonies and should they continue to be used in court?</p> <p>Girls in Computer Science</p> <p>To what extent do western adults suffer from psychosomatic pain and how does that affect them?</p> <p>Impact of racism on Indigenous Australians</p> <p>Dance related topics</p> <p>PE related topics</p>
31	<p>To what extent does range of motion in the shoulder impact the performance of a freestyle swimmer?</p> <p>To what extent does Orthokeratology slow the progression of childhood myopia, thus reducing the risk of glaucoma?</p> <p>To what extent will private space mining affect land appropriation laws regarding space activities?</p>
34	<p>What are the potential emotional and physical health consequences associated with Problem Acne and how does this impact teenagers?</p> <p>To what extent are Australia's asylum seeker policies following international laws and what is the impact of this?</p> <p>What are the processes involved in creating a video advertisement for promoting Adelaide.</p>
37	<p>To what extent does sleep deprivation affect school performance?</p> <p>To what extent does a toddler's diet affect cognitive function and how can childcare centres optimise this?</p> <p>What are the most significant factors that limit post-school opportunities for Aboriginal children in remote areas?</p>
39	<p>Producing an orienteering map</p> <p>Islamophobia and the Australian media</p> <p>Hollywood Ten - Communism and the American film industry</p>
41	<p>Are the support and interventions for hearing impaired students effective in improving academic performance?</p> <p>To what extent does blindfolded Rubik's Cube solving affect memory and concentration, and which memory methods are most effective?</p>

Presentations

Time	Topic	Presenter
Session 1		
9.30 am	Using Google products to improve your Research Project	Emil Zankov Google Certified Teacher
10.00 am	Q&A – The benefits of completing the Research Project	Panel of university students, The University of Adelaide
10.30 am	6 Tips for Conducting Research	Ella Ward Ehrenberg-Bass Institute for Marketing Science, UniSA
Session 2		
11.30 am	6 Tips for Conducting Research	Ella Ward Ehrenberg-Bass Institute for Marketing Science, UniSA
12.00 pm	How SASI Researches Podium Potential	Mark Gregory Personal Excellence Senior Adviser, SASI
12.30 pm	Research Projects in 3 Minutes	Panel of university students Flinders University
Session 3		
1.30 pm	Choosing your research Topic: A Helpful Guide	Elijah Price The University of Adelaide
2.00 pm	The Art Gallery of South Australia – a place for curiosity and discovery	Kylie Neagle The Art Gallery of South Australia
2.30 pm	Research projects that investigated issues relating to food and nutrition	Dr Jim Ralph Principal Lecturer, Applied Food Studies, TAFE SA

Presentations by the SACE Board of SA

Time	Topic	Presenter
Session 1		
9.45 am	Structure of the Research Project subject	Luke Nash SACE Board of South Australia
10.15 am	How do I analyse sources?	Suzie Rust RP Teacher, Tyndale Christian School
Session 2		
11.45 am	How to refine a topic to a research question	Simone Nash RP Teacher, Modbury High School
12.15 pm	How to decide on research processes	Jane Marshall RP Teacher, Craigmore High School
Session 3		
1.45 pm	What is meant by ethical approaches to research?	Jasmin Parasiers RP Teacher, St. Mary's College
2.15 pm	How will you be assessed in Research Project?	Adele Broster SACE Board of South Australia

Visit us at booths 43 and 44 – we can answer specific questions about the Research Project, together with presentations offering information and advice on the subject. You can also visit 360 Q&A (booth 42) to add to our living-graphic: leave comments, suggestions, general feedback or questions and submit your completed **passport** for a chance to win one of five prizes!

Exhibiting Organisations

Booth	Organisation	Booth	Organisation
1, 2 & 3	CITB Doorways 2 Construction	27	The Art Gallery of South Australia
6	ASC	28	Airborne Research Australia
7, 8 & 9	Australia and New Zealand Driverless Vehicle Initiative	32	AgCommunicators
11 & 12	Flinders University	33	State Library of South Australia
13	TAFE SA	35 & 38	Australian Youth Aerospace Association
14	CQUniversity Adelaide	36	Australia's Science Channel
15	NRM Education	40	State Records of South Australia
21	South Australian Sports Institute	42	360 Q&A (submit passport here)
24	Association of Secondary Research Teachers	43 & 44	SACE Board
25 & 26	The University of Adelaide		

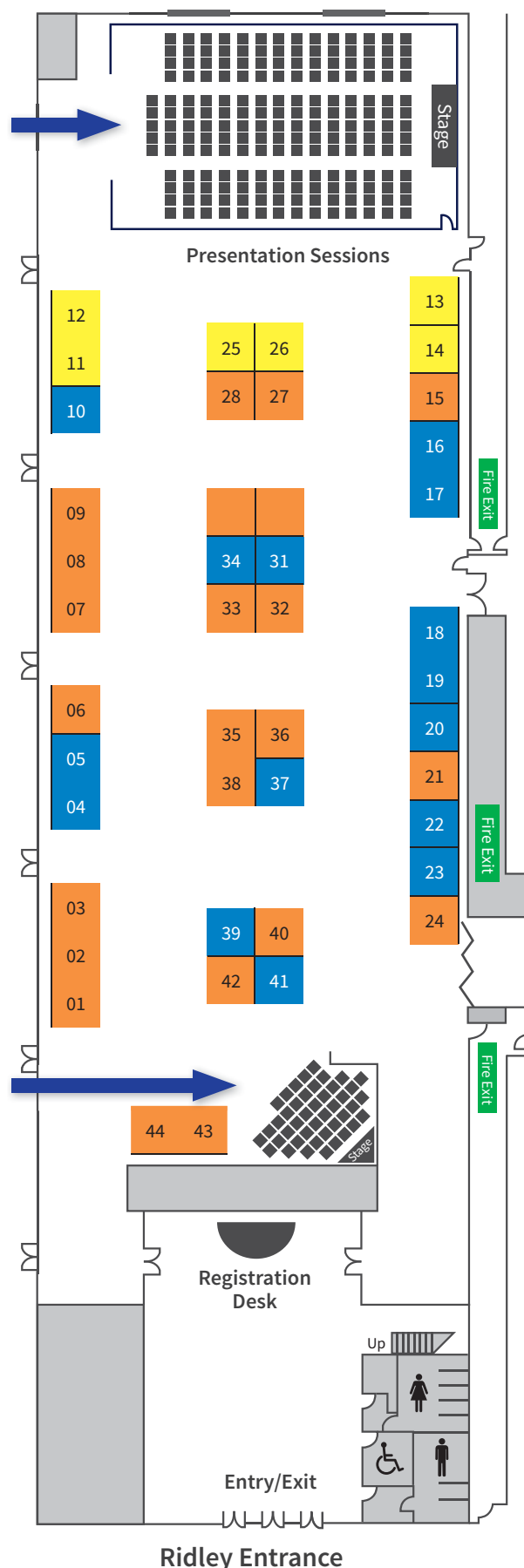

Legend

Organisation
 Tertiary
 Student Exhibitor