

RESEARCH PROJECT STUDENT EXPO

Program & map

Wednesday 10 August 2016

sace.sa.edu.au/expo2016

#RPstudentexpo

Student Exhibitors

Booth	Research Project Title
4 & 5	<p>How does and how can video gaming truly impact today's youth?</p> <p>How do the biomechanics and footstrike of a barefoot marathon runner affect the lower limb injury rate when compared to a shod runner?</p> <p>What rehabilitation programs are available to help a stroke survivor regain speech and mobility?</p> <p>Is there a link between cannabis use and mental illness?</p>
15 & 16	<p>Which marketing strategies will be most effective in appealing to women aged 15-25 for top end Australian women's fashion labels?</p> <p>Why do 40% of premature babies have fine motor skill impairments? How can the early intervention of occupational therapy help when the child is under 5?</p> <p>How is the attitude towards body image portrayed among 16-17 year old girls in my high school and how does it differ from adolescents elsewhere?</p> <p>How can you successfully develop a magazine aimed at the Australian teenage female population?</p> <p>Why should Australian Aboriginal languages be preserved?</p>
18	<p>To what extent does the peer review system impede the progress of scientific research?</p> <p>To what extent can an individual's sense of security be achieved?</p> <p>Is being a high achieving academic Aboriginal student a burden or a responsibility?</p>
21 & 22	<p>What do we currently know about auditory processing disorder and should all kids be treated?</p>
26	<p>A range of sporting-themed projects</p>

Booth	Research Project Title
31	<p>What are the emotional side effects for the friends and family of someone going through cancer treatment?</p> <p>In what ways do high levels of sugar in diets affect the health and well-being of youth between the ages of 15 and 30?</p> <p>What are the key ways that depression impacts a teenager's performance in school conditions?</p>
32	<p>The significance of Renaissance art</p> <p>Second language acquisition</p>
35	<p>To what extent does reading fiction benefit well-being?</p> <p>To what extent does trauma affect a police officer's life?</p> <p>To what extent does viewing a film stimulate brain activity?</p> <p>To what extent are battery electric vehicles more viable than hydrogen fuel cell vehicles and internal combustion engine vehicles for sustainable transport in the near future?</p>
36 & 37	<p>School radio station</p> <p>Italian weddings</p> <p>Benefits of exercise during study</p> <p>Calisthenics and warm-ups</p> <p>Popularity of cruise ships</p> <p>The benefits of learning Spanish</p> <p>Competitive swimming and diet</p> <p>Fundraising for hydrocephalus</p>

Presentations

Time	Topic	Presenter
Session 1		
9.45 am	Everything you need to know from those who have been there	Panel of university students Flinders University
10.15 am	What you need to know about conducting market research	Ella Ward Ehrenberg-Bass Institute for Marketing Science, UniSA
Session 2		
11.15 am	How to start a research project	Panel of university students UniSA
11.45 am	Collecting and analysing magnetic geophysical data	Alan Brenchley & Rod Austin TAFE SA
12.15 pm	How to choose your research topic	The University of Adelaide
Session 3		
1.15 pm	Q & A with current students	Panel of university students The University of Adelaide
1.45 pm	Research in 3 minutes and thinking about your own project	Panel of university students Flinders University
2.15 pm	Research projects that investigate issues relating to food and nutrition	Jim Ralph TAFE SA

Presentations by the SACE Board of SA

Time	Topic
Session 1	
9.30 am	What is the Research Project – Introduction
10.00 am	Getting Started – Question Design
Session 2	
11.30 am	What is the Research Project – Introduction
12.00 pm	Getting Started – Question Design
Session 3	
1.30 pm	What is the Research Project – Introduction
2.00 pm	Getting Started – Question Design

Visit us at booths 40 and 41 – we can answer specific questions that you have about the Research Project, together with presentations offering information and advice on the subject.

Exhibiting Organisations

Booth	Organisation	Booth	Organisation
1, 2 & 3	CITB – Doorways2Construction – Redstack	23	Association of Secondary Research Teachers
6	ASC (Australian Submarine Corp)	24 & 27	The University of Adelaide
7	Academy of Interactive Entertainment	25	SHAPE Research Centre
9	CQUniversity	28	CSIRO Education & Outreach
10	Airborne Research Australia	29	State Library of South Australia
11 & 12	Flinders University	30	Food and Fibre Education SA
13 & 14	TAFE SA	33	Cancer Council SA
17	NRM Education	38	Engineers Without Borders
20	Australian Driverless Vehicle Initiative	39	State Records of South Australia

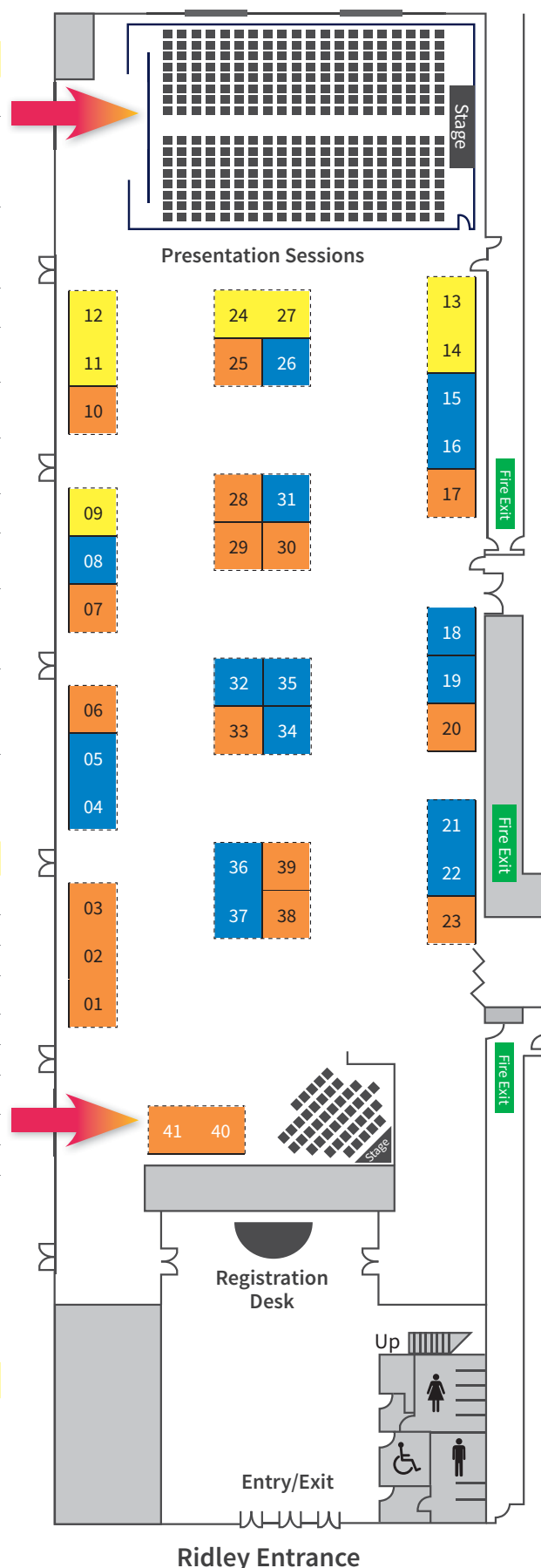

Legend

Organisation
 Tertiary
 Student Exhibitor