

RESEARCH PROJECT STUDENT EXPO

Program & map

Tuesday 9 August 2016

sace.sa.edu.au/expo2016

#RPstudentexpo

Student Exhibitors

Booth	Research Project Title
4 & 5	<p>How does stress impact on an individual's sporting performance?</p> <p>How well are the contemporary realities being addressed in order to safeguard the paramedics in today's society?</p> <p>How viable is renewable energy in developing countries to aid economic development, health care and education?</p> <p>How can a young basketballer dramatically improve his vertical jump and explosiveness through use of a basketball-specific athletic training programme?</p> <p>How can a gluten-free waffle cone be produced for coeliac customers at Royal Copenhagen ice-creamery?</p>
8	<p>Trail running</p> <p>Spin of a tennis ball</p> <p>What is the process of producing a specialist cake?</p>
15 & 16	<p>How can I use a drone for crop mapping?</p> <p>Immunisations</p> <p>Should food be genetically modified?</p> <p>What is art therapy, and does it benefit mental health?</p> <p>To what extent does rewarding all junior sports participants impact them?</p> <p>To what extent does language vary across Australia?</p> <p>What must be considered when designing a rollercoaster?</p> <p>To what extent do the values of club or country influence the colour and design of association football uniforms?</p>
18	<p>What is the impact of the language barrier on Australia's imports and exports?</p> <p>How could the Barossa Valley sustain itself as an independent country?</p> <p>In what ways can mastering a foreign language influence the way we think?</p> <p>What influences consumer choice in regard to using card over cash as a primary payment method?</p>
19	<p>What needs to be considered when planning a holiday to the UK?</p>
21 & 22	<p>How can I make an Adirondack chair and a matching footstool and where has the design originated from?</p> <p>What is the process of getting a tattoo?</p> <p>What are the steps in repairing a chainsaw?</p>

Booth	Research Project Title
26	<p>How does protein aid in muscle growth and repair in track sprint cycling athletes and what is the right type and amount?</p> <p>A range of sporting-themed projects</p>
28	<p>Gender stereotypes in dance</p> <p>To what extent does the media accurately represent what happened in Gallipoli in 1915?</p> <p>The difference between the education systems in Australia and Japan</p>
31	<p>What were the key factors that helped to establish Alice Springs as a permanent settlement in the NT?</p> <p>To what extent is live export/transport humane?</p> <p>In what ways does horse racing affect the mental and physical wellbeing of thoroughbred racehorses in Australia?</p>
32	<p>Students' sleeping habits</p> <p>Key aspects of establishing a small business</p> <p>The feasibility of hydrogen engines in the future</p> <p>The evolution of the Sims</p>
35	<p>What is digital marketing and is it more effective than other forms of media marketing?</p> <p>What is the most effective method for managing nuclear waste in SA?</p> <p>To what extent does playing Magic the Gathering improve critical thinking?</p> <p>How effective are current Australian Government initiatives in reducing teenage smoking in SA?</p>
36 & 37	<p>School radio station</p> <p>Italian weddings</p> <p>The benefits of learning Spanish</p> <p>Eco friendly housing</p> <p>Adelaide and the international touring deficit</p> <p>Competitive swimming and diet</p> <p>Fundraising for hydrocephalus</p>



Government
of South Australia

SACE
Board of SA

Presentations

Time	Topic	Presenter
Session 1		
9.45 am	Everything you need to know from those who have been there	Panel of university students Flinders University
10.15 am	What you need to know about conducting market research	Ella Ward Ehrenberg-Bass Institute for Marketing Science, UniSA
Session 2		
11.15 am	What you need to know about conducting market research	Ella Ward Ehrenberg-Bass Institute for Marketing Science, UniSA
11.45 am	Q&A with current Research Students	Panel of university students, The University of Adelaide
12.15 pm	Making the most of Google Search	Penny Collins Google Certified Teacher
Session 3		
1.15 pm	Collecting data for the study of human culture	Penny Collins Google Certified Teacher
1.45 pm	How to choose your research topic	The University of Adelaide
2.15 pm	Research in 3 minutes and thinking about your own project	Panel of university students Flinders University

Presentations by the SACE Board of SA

Time	Topic
Session 1	
9.30 am	What is the Research Project – Introduction
10.00 am	Getting Started – Question Design
Session 2	
11.30 am	What is the Research Project – Introduction
12.00 pm	Getting Started – Question Design
Session 3	
1.30 pm	What is the Research Project – Introduction
2.00 pm	Getting Started – Question Design

Visit us at booths 40 and 41 – we can answer specific questions that you have about the Research Project, together with presentations offering information and advice on the subject.

Exhibiting Organisations

Booth	Organisation	Booth	Organisation
1, 2 & 3	CITB – Doorways2Construction – Redstack	23	Association of Secondary Research Teachers
6	ASC (Australian Submarine Corp)	24 & 27	The University of Adelaide
7	Academy of Interactive Entertainment	25	SHAPE Research Centre
9	CQUniversity	29	State Library of South Australia
10	Airborne Research Australia	30	Food and Fibre Education SA
11 & 12	Flinders University	33	Cancer Council SA
13 & 14	TAFE SA	38	Engineers Without Borders
17	NRM Education	39	State Records of South Australia
20	Australian Driverless Vehicle Initiative		

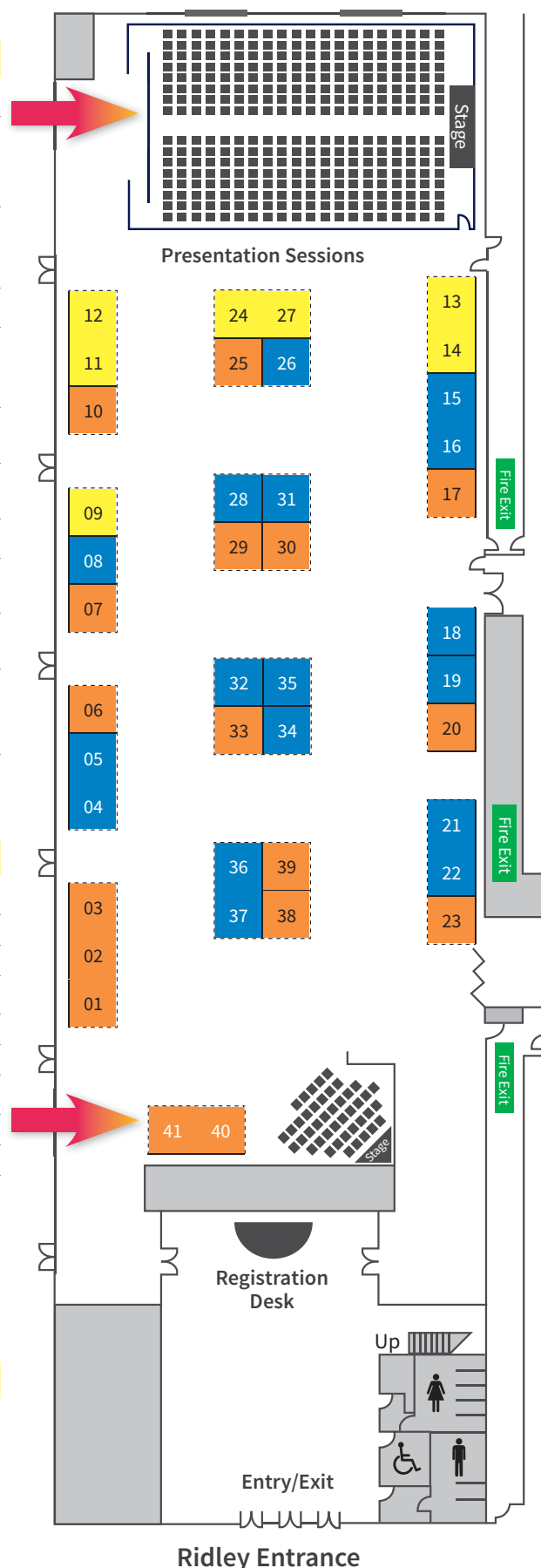

Legend

Organisation
 Tertiary
 Student Exhibitor