

RESEARCH PROJECT STUDENT EXPO

Program & map

Thursday 13 August 2015

Student Exhibitors

Booth Research Project Title

- 2 & 3**
- The relationship between media and the foodie culture
 - Physical characteristics needed by AFL footballers
 - How coeliac disease affects a family

How would Australian national surrogacy laws benefit parents, surrogates and children?
What are all the features and benefits of the human placenta?

- 5 & 6**
- To what extent can the arguments supporting gun rights in America be disproved?
 - What characteristics make personal trainers effective and successful?

What specific evidence shows the relationship between sleep and mental health?

What are the most challenging aspects of building a cajon?

To what extent does social media affect happiness?

To what extent do peritoneal and haemodialysis differ, and which best supports a kidney disease patient's lifestyle?

- 8 & 9**
- How does motor-racing help underage drivers improve their driving skills?

Why do South Africans immigrate and how typical is my family's experience of immigration to Australia?

Psychology in sport

- 17**
- To what extent do the benefits of social media use by teenagers outweigh the negative impacts?
 - Dyslexia

What principles affect aerofoils to produce lift, and why are there differing opinions?

Are stem cell transplants the best way to treat patients with leukaemia?

How do we biologically explain and consciously find meaning in dreams?

- 19 & 20**
- How accepting is the SA public of the construction characteristics and pricing of sustainable architecture?

How does the representation of female video game characters affect the people who play these games?

Should nuclear energy be developed in Australia?

Are traditional or electronic toys more beneficial to children for language development?

How effective is cognitive-behavioural therapy in the treatment of obsessive compulsive disorder

- 26 & 27**
- How can I best manufacture and market decorative, scented candles?

Similarities in Australian Aboriginal and Maori creation stories and what messages they teach

Booth Research Project Title

- 26 & 27**
- How does Auslan (Australian Sign Language) benefit children?
 - How is one able to start shoutcasting or competitive e-sports at a professional level?
 - How do artists construct characters within manga novels?

Will Google Glass challenge the status quo of society, laws and ethics?

What are the effects of parental and peer teasing on body image amongst SA adolescents?

- 29 & 30**
- How to choose a complimentary pair of glasses?
 - How can I create a piece of visual art that positively stimulates the emotions of patients in hospice?

Is benzoyl peroxide effective as a treatment for acne?

What are the differences in marketing strategies employed by upmarket and generic labels selling clothing to female adolescents?

- 31 & 32**
- How does the C-Bus (electrical) system work?
 - Can I successfully restore and fix a Datsun ute without spending too much money?

What are the mental and physical health benefits of exercising during Year 12?

- 35**
- How can a specialised diet reduce health complications occurring in an end-stage kidney disease patient?

Social media and risky behaviour

Restoring Vietnamese cultural identity

Portrayal of colonisation in Australian literature

'Nature vs nature' in serial killer Martin Bryant

- 36**
- Black holes
 - Electronic cigarettes
 - Year 12 optimal nutrition
 - Ethical ramifications of misogynistic video games

G.M. foods (9am – 11am)

Social media (9am – 11am)

- 37**
- Gaming magazine (11am – 1pm)
 - Aviation technology (11am – 1pm)
 - Cookbook product (1pm – 3pm)
 - Childcare report (1pm – 3pm)

What is the ideal piano that will assist me to achieve my goals as a pianist?

- 38**
- Why is natural horsemanship so useful in strengthening the bond between horse and rider? Can it be used to successfully train a horse to jump?

What characteristics of video games cause aggression in teenagers?

What is the most effective way to harvest a canola crop?

How can different training techniques be adapted to properly train for an endurance ride?

- 40**
- The illusion behind magic tricks and perception
 - How can children learn emotional resilience?

Should homosexual marriage be legalised in Australia and modern society?

Presentation Schedule

Time	Topic	Presenter
Session 1		
9.15am	Research saves lives	Tony Ashdown SAHMRI
9.35am	Advanced research at Adelaide – A student perspective	Natasha Atkins & Chantelle Valente The University of Adelaide
9.55am	Research Project: Everything you need to know from those who've been there	Panel of university students Flinders University
Session 2		
11.15am	Using Google forms as a data collection tool	Emil Zankov Google Certified Teacher
11.35am	How to choose your research topic	Facilitator: Ari Traucki Panel of university students The University of Adelaide
11.55am	How to start a research project	Facilitator: Sarah Armour & Sharon Scott Panel of university students University of South Australia
Session 3		
1.15pm	Q&A with current research students	Facilitator: Ari Traucki Panel of university students The University of Adelaide
1.35pm	From #fitspo to medicine – Research in 3 minutes and thinking about your own project	Facilitator: Office of Graduate Research Panel of university students Flinders University

The SACE Board of South Australia is proud to present the Research Project Student Expo.

Visit us at booths 41 and 42 – we can answer specific questions you might have about the Research Project.

Research Project teachers and SACE Board staff are available to provide students and teachers with hints and tips, together with presentations including student story videos, and Prezi presentations offering information and advice on the subject.

sace.sa.edu.au/expo2015

Exhibiting Organisations

Booth	Organisation
1	Agriculture, Food and Wine
4	Australian Institute of Fitness
7	Natural Resources
10	Airborne Research Australia
11 & 12	Flinders University
13 & 14	TAFE SA
15 & 16	Department for State Development
18	Cancer Council SA
21 & 22	ESL Student and Teacher Support
23 & 24	Association of Secondary Research Teachers
25 & 28	The University of Adelaide
33 & 34	State Library of South Australia
39	ASC (Australian Submarine Corp)
41 & 42	SACE Board of South Australia

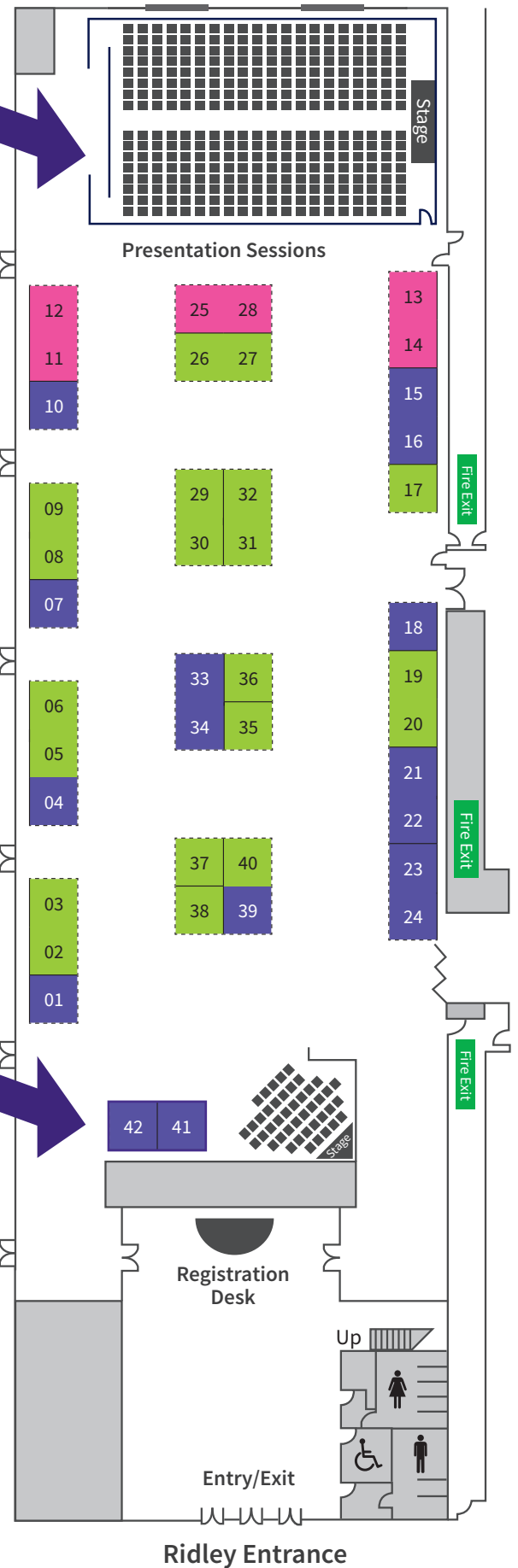

Legend

- Organisation
- Tertiary
- Student Exhibitor